

SECTION 15
Branching valves
Reduced bore

BROEN
BALLOMAX®

Designed to last

Branching valve - DN 20 - 100, PN 40/25

Type 63102 - Reduced bore

Welding × Welding

Fully welded steel ball valve.

Materials

See next page.

Applications

Branching valve for heating systems, district heating, cooling and industrial purpose.

Media

Water. Not suitable for steam. Other media on request. If in doubt, please contact BROEN BALLOMAX® Sales Department.

Surface treatment

Eco-friendly protection finish against corrosion.

Operation

Branching valve with a cap screw and a hexagon for a HEX top. The spindle has a notch for indication of position.

Notice

It is recommended that you read the "User manual for BROEN BALLOMAX® branching valves".

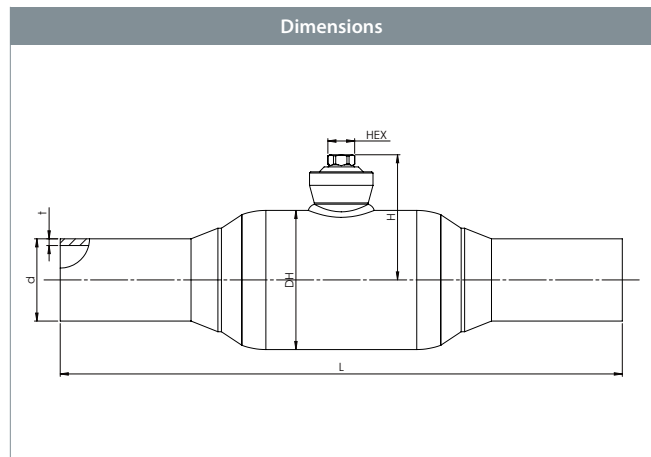
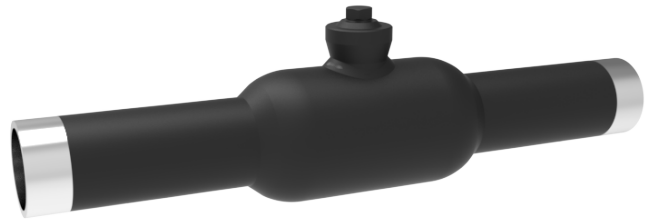

PN 40					All dimensions in mm					
DN	BROEN No.	Bore	Kvs	net Weight kg	HEX	H	DH	L	d	t
20	6310240020 000	15	15	0,6	10	43,3	42,4	230	26,9	2,3
25	6310240025 000	20	27	1,2	10	47,6	51,0	230	33,7	2,6
32	6310240032 000	25	40	1,7	10	51,3	57,0	260	42,4	2,6
40	6310240040 000	32	69	2,4	10	61,2	76,1	260	48,3	2,6
50	6310240050 000	40	110	3,4	10	66,5	88,9	300	60,3	2,9

PN 25					All dimensions in mm					
DN	BROEN No.	Bore	Kvs	net Weight kg	HEX	H	DH	L	d	t
65	6310225065 000	50	180	5,3	13	77,0	108,0	360	76,1	2,9
80	6310225080 000	65	288	7,3	13	87,6	127,0	370	88,9	3,2
100	6310225100 000	80	470	11,3	19	105,9	152,4	390	114,3	3,6

Branching valve - DN 20 - 100, PN 40/25

Type 63102 - Reduced bore

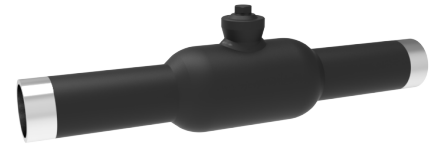

Technical drawing		Material description	
	1	Welding	Steel - P235GH / 1.0345 / EN 10217-2
	5	Valve body	Steel - P235GH / 1.0345 / EN 10217-2
	6	Ball	Stainless steel - AISI304L / 1.4306 / EN 10217-7
	7	Seat ring	PTFE 20% Carbon
	8	Back-up ring	Steel - DC01 / 1.0330 / EN 10130
	9	Disc spring	Steel - C75S / 1.1248 / EN 10132-4
	11	Stem guide	Steel - S355J2+N / 1.0570 / EN 10025-2
	12	Stem	Stainless steel - ASTM420 / 1.4021 / EN 10088-3
	17	O-ring	EPDM70
	37	Pipe plug	Steel - S355J2 / 1.0570 / EN 10025-2

Branching valve - DN 40 - 100, PN 40/25

Type 63102 - Reduced bore with sleeve in ball

Welding × Welding

Fully welded steel ball valve.

Materials

See next page.

Applications

Branching valve for heating systems, district heating, cooling and industrial purpose.

Media

Water. Not suitable for steam. Other media on request. If in doubt, please contact BROEN BALLOMAX® Sales Department.

Surface treatment

Eco-friendly protection finish against corrosion.

Operation

Branching valve with a cap screw and a hexagon for a HEX top. The spindle has a notch for indication of position.

Notice

It is recommended that you read the "User manual for BROEN BALLOMAX® branching valves".

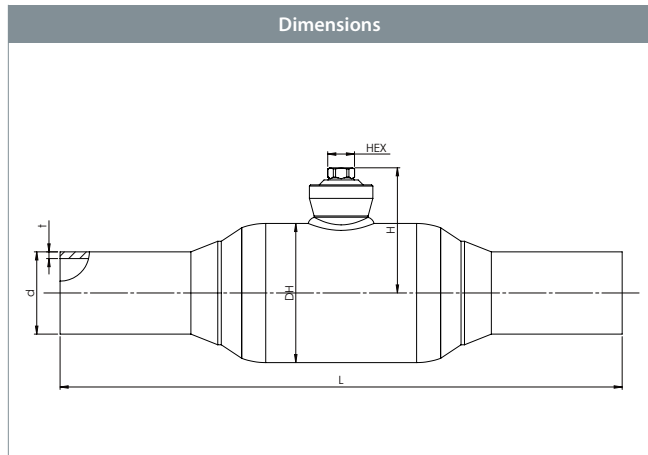
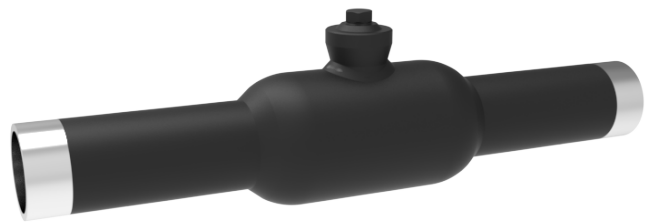

PN 40					All dimensions in mm					
DN	BROEN No.	Bore	Kvs	net Weight kg	HEX	H	DH	L	d	t
40	6390240040 000	32	78	2,4	10	61,2	76,1	260	48,3	2,6
50	6390240050 000	40	124	3,4	10	66,5	88,9	300	60,3	2,9

PN 25					All dimensions in mm					
DN	BROEN No.	Bore	Kvs	net Weight kg	HEX	H	DH	L	d	t
65	6390225065 000	50	199	5,3	13	77,0	108,0	360	76,1	2,9
80	6390225080 000	65	310	7,3	13	87,6	127,0	370	88,9	3,2
100	6390225100 000	80	512	11,3	19	105,9	152,4	390	114,3	3,6

Branching valve - DN 40 - 100, PN 40/25

Type 63102 - Reduced bore with sleeve in ball



Technical drawing		Material description	
	1	Welding	Steel - P235GH / 1.0345 / EN 10217-2
	5	Valve body	Steel - P235GH / 1.0345 / EN 10217-2
	6	Ball	Stainless steel - AISI304L / 1.4306 / EN 10217-7
	7	Seat ring	PTFE 20% Carbon
	8	Back-up ring	Steel - DC01 / 1.0330 / EN 10130
	9	Disc spring	Steel - C75S / 1.1248 / EN 10132-4
	11	Stem guide	Steel - S355J2+N / 1.0570 / EN 10025-2
	12	Stem	Stainless steel - ASTM420 / 1.4021 / EN 10088-3
	17	O-ring	Rubber - EPDM70
	37	Pipe plug	Steel - S355J2 / 1.0570 / EN 10025-2

Branching valve - DN 125 - 200, PN 25

Type 63102 - Reduced bore

Welding × Welding

Fully welded steel ball valve.

Materials

See next page.

Applications

Branching valve for heating systems, district heating, cooling and industrial purpose.

Media

Water. Not suitable for steam. Other media on request. If in doubt, please contact BROEN BALLOMAX® Sales Department.

Surface treatment

Eco-friendly protection finish against corrosion.

Operation

Branching valve with a cap screw and a hexagon for a HEX top. The spindle has a notch for indication of position.

Notice

It is recommended that you read the "User manual for BROEN BALLOMAX® branching valves".

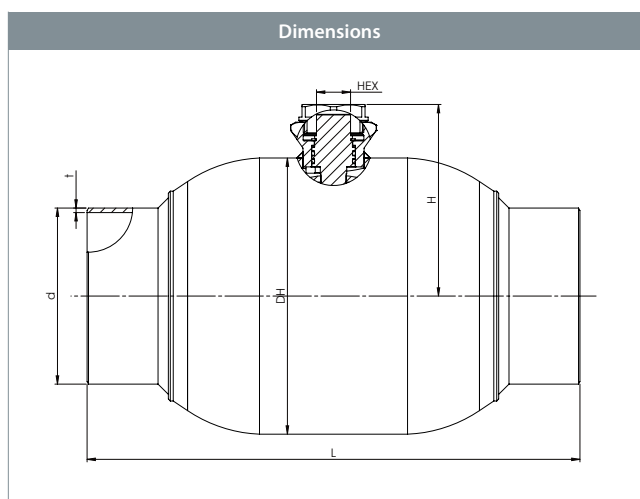

DN	BROEN No.	Bore	Kvs	net Weight kg	All dimensions in mm						
					HEX	6-kt.	H	DH	L	d	t
125	6310225125 000	100	699	14,3	19	120,0	177,8	178,0	390	139,7	3,6
150	6310225150 000	125	1046	20,4	27	149,0	219,1	219,0	390	168,3	4,0
200	6310225200 000	150	1500	33,3	27	165,9	267,0	267,0	390	219,1	4,5

Branching valve - DN 125 - 200, PN 25

Type 63102 - Reduced bore



Technical drawing		Material description	
	1	Welding	Steel - P235GH / 1.0345 / EN 10217-2
	5	Valve body	Steel - P235GH / 1.0345 / EN 10217-2
	6	Ball	Stainless steel - AISI304L / 1.4306 / EN 10217-7
	7	Seat ring	PTFE 20% Carbon
	8	Back-up ring	Steel - DC01 / 1.0330 / EN 10130
	9	Disc spring	Steel - C75S / 1.1248 / EN 10132-4
	11	Stem guide	Steel - S355J2+N / 1.0570 / EN 10025-2
	12	Stem	Stainless steel - ASTM420 / 1.4021 / EN 10088-3
	13	Stem washer	Stainless steel - AISI304 / 1.4301 / EN 10088-3
	15	O-ring	EPDM70
	16	Back-up ring	PTFE 20% Carbon
	17	O-ring	FPM70
	18	Intermediate ring	Stainless steel - AISI303 / 1.4305 / EN 10088-3
	25	Friction gasket	PTFE 20% Carbon
	30	Circlip	Steel
	35	Branching washer	PTFE 20% Carbon
36	Branching plug	Steel - S355J2+N / 1.0570 / EN 10025-2	

