

SECTION 14
Branching valves
Full bore

BROEN
BALLOMAX®

Designed to last

Branching valve - DN 15 - 50, PN 40

Type 63602 - Full bore

Welding × Welding

Fully welded steel ball valve.

Materials

See next page.

Applications

Branching valve for heating systems, district heating, cooling and industrial purpose.

Media

Water. Not suitable for steam. Other media on request. If in doubt, please contact BROEN BALLOMAX® Sales Department.

Surface treatment

Eco-friendly protection finish against corrosion.

Operation

Branching valve with a cap screw and a hexagon for a HEX top. The spindle has a notch for indication of position.

Notice

It is recommended that you read the "User manual for BROEN BALLOMAX® branching valves".

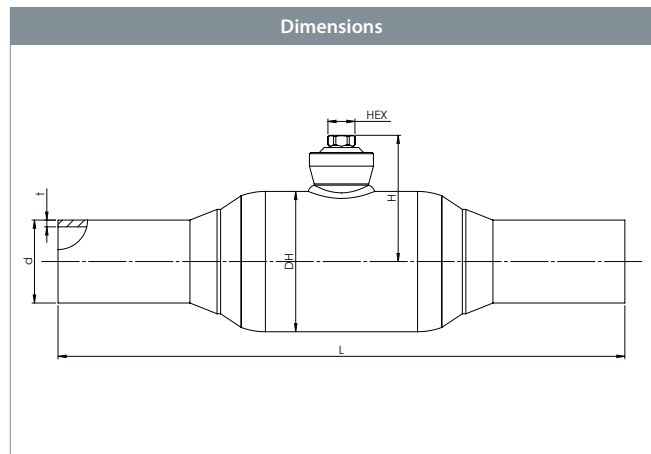
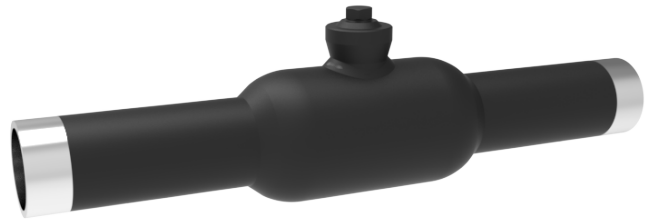

DN	BROEN No.	Bore	Kvs	net Weight kg	All dimensions in mm					
					HEX	H	DH	L	d	t
15	6360240015 000	15	32	0,6	10	43,3	42,4	210	21,3	2,0
20	6360240020 000	20	57	1,2	10	46,6	51,0	230	26,9	2,3
25	6360240025 000	25	81	1,7	10	51,3	57,0	230	33,7	2,6
32	6360240032 000	32	133	2,4	10	61,2	76,1	260	42,4	2,6
40	6360240040 000	40	229	3,1	10	66,5	88,9	260	48,3	2,6
50	6360240050 000	50	295	5,4	13	77,0	108,0	300	60,3	2,9

Branching valve - DN 15 - 50, PN 40

Type 63602 - Full bore

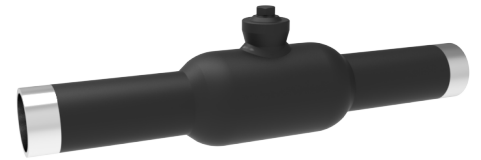

Technical drawing		Material description	
	1	Welding	Steel - P235GH / 1.0345 / EN 10217-2
	5	Valve body	Steel - P235GH / 1.0345 / EN 10217-2
	6	Ball	Stainless steel - AISI304L / 1.4306 / EN 10217-7
	7	Seat ring	PTFE 20% Carbon
	8	Back-up ring	Steel - DC01 / 1.0330 / EN 10130
	9	Disc spring	Steel - C75S / 1.1248 / EN 10132-4
	11	Stem guide	Steel - S355J2+N / 1.0570 / EN 10025-2
	12	Stem	Stainless steel - ASTM420 / 1.4021 / EN 10088-3
	17	O-ring	EPDM70
	37	Pipe plug	Steel - S355J2 / 1.0570 / EN 10025-2

Branching valve - DN 65 - 100, PN 25

Type 63602 - Full bore

Welding × Welding

Fully welded steel ball valve.

Materials

See next page.

Applications

Branching valve for heating systems, district heating, cooling and industrial purpose.

Media

Water. Not suitable for steam. Other media on request. If in doubt, please contact BROEN BALLOMAX® Sales Department.

Surface treatment

Eco-friendly protection finish against corrosion.

Operation

Branching valve with a cap screw and a hexagon for a HEX top. The spindle has a notch for indication of position.

Notice

It is recommended that you read the "User manual for BROEN BALLOMAX® branching valves".

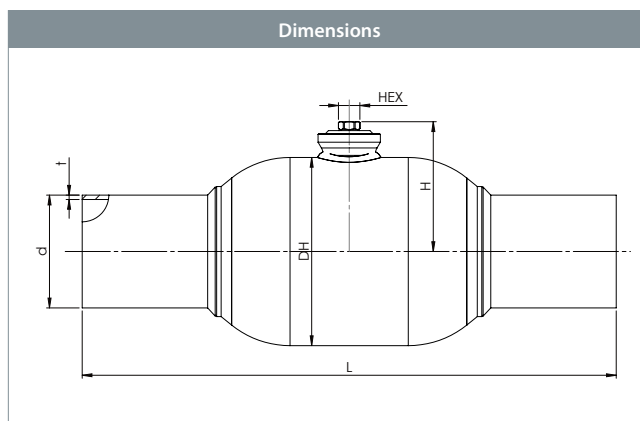

DN	BROEN No.	Bore	Kvs	net Weight kg	All dimensions in mm					
					HEX	H	DH	L	d	t
65	6360225065 000	65	498	7,1	13	87,6	127,0	360	76,1	2,9
80	6360225080 000	80	754	12,1	19	105,9	152,4	370	88,9	3,2
100	6360225100 000	98	1159	17,4	19	120,0	177,8	390	114,3	3,6

Branching valve - DN 65 - 80, PN 25

Type 63602 - Full bore



Technical drawing		Material description	
	1	Welding	Steel - P235GH / 1.0345 / EN 10217-2
	5	Valve body	Steel - P235GH / 1.0345 / EN 10217-2
	6	Ball	Stainless steel - AISI304L / 1.4306 / EN 10217-7
	7	Seat ring	PTFE 20% Carbon
	8	Back-up ring	Steel - DC01 / 1.0330 / EN 10130
	9	Disc spring	Steel - C75S / 1.1248 / EN 10132-4
	11	Stem guide	Steel - S355J2+N / 1.0570 / EN 10025-2
	12	Stem	Stainless steel - ASTM420 / 1.4021 / EN 10088-3
	17	O-ring	EPDM70
	38	Pipe plug	Steel - S355J2+N / 1.0570 / 1.0025-2

Branching valve - DN 125 - 150, PN 25

Type 63602 - Full bore

Welding × Welding

Fully welded steel ball valve.

Materials

See next page.

Applications

Branching valve for heating systems, district heating, cooling and industrial purpose.

Media

Water. Not suitable for steam. Other media on request. If in doubt, please contact BROEN BALLOMAX® Sales Department.

Surface treatment

Eco-friendly protection finish against corrosion.

Operation

Branching valve with a cap screw and a hexagon for a HEX top. The spindle has a notch for indication of position.

Notice

It is recommended that you read the "User manual for BROEN BALLOMAX® branching valves".

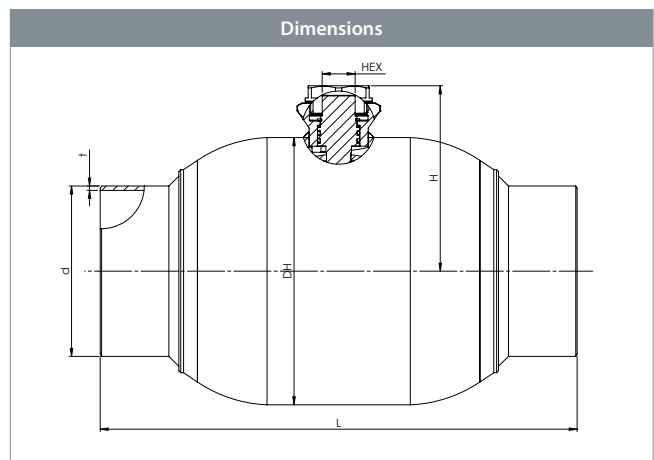

DN	BROEN No.	Bore	Kvs	net Weight kg	All dimensions in mm					
					HEX	DH	L	H	d	t
125	63602125 000	125	1841	22,6	HEX 27	219	390	147,5	139,7	3,6
150	63602150 000	150	2652	28,4	HEX 27	267	390	169,0	168,3	4,0

Branching valve - DN 125 - 150, PN 25

Type 63602 - Full bore



Technical drawing		Material description	
	1	Welding	Steel - P235GH / 1.0345 / EN 10217-2
	5	Valve body	Steel - P235GH / 1.0345 / EN 10217-2
	6	Ball	Stainless steel - AISI304L / 1.4306 / EN 10217-7
	7	Seat ring	PTFE 20% Carbon
	8	Back-up ring	Steel - DC01 / 1.0330 / EN 10130
	9	Disc spring	Steel - C75S / 1.1248 / EN 10132-4
	11	Stem guide	Steel - S355J2+N / 1.0570 / EN 10025-2
	12	Stem	Stainless steel - ASTM420 / 1.4021 / EN 10088-3
	13	Stem washer	Stainless steel - AISI304 / 1.4301 / EN 10088-3
	15	O-ring	EPDM70
	16	Back-up ring	PTFE 20% Carbon
	17	O-ring	FPM70
	18	Intermediate ring	Stainless steel - AISI303 / 1.4305 / EN 10088-3
	25	Friction gasket	PTFE 20% Carbon
	30	Circlip	Steel
	35	Branching washer	PTFE 20% Carbon
36	Branching plug	Steel - S355J2+N / 1.0570 / EN 10025-2	

